

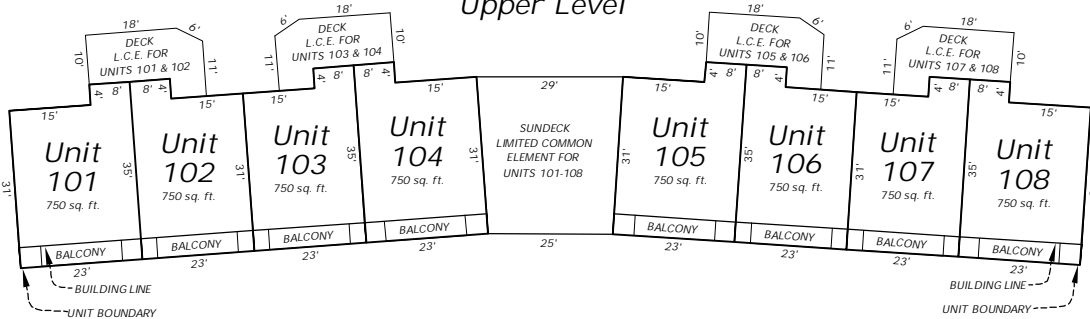

First Addendum to Lake Forest Resort & Club a condominium

Town of Washington
Vilas County, Wisconsin

Units 101-108 Upper Level



Lower Level

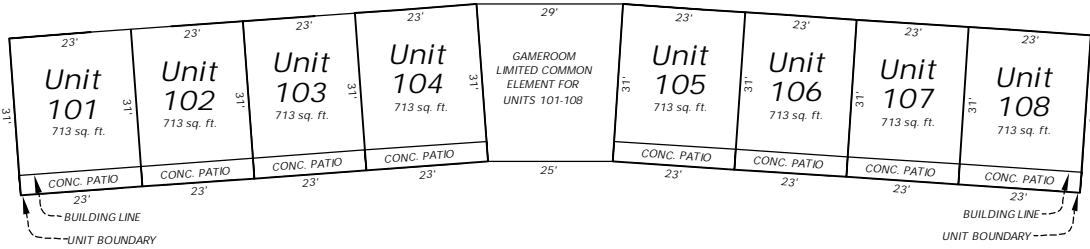

Units 109-116 Upper Level

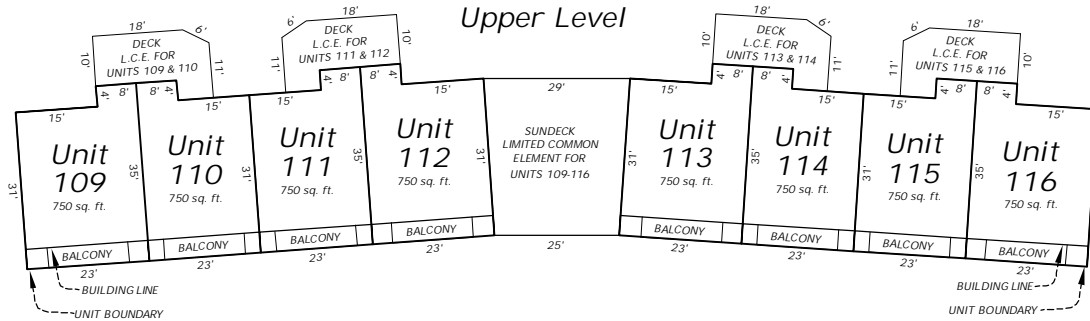

Lower Level

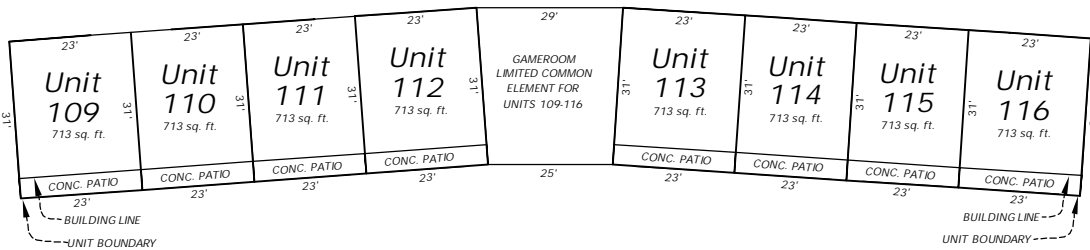

NOTES:
FOR BUILDING LOCATIONS AND
ORIENTATION SEE SHEET 1

EACH UNIT CONTAINS 2 BEDROOMS

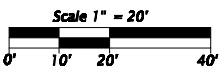

**Favorite, Anderson & Malnes
Surveying, S.C.**

5230 HWY 70 WEST - EAGLE RIVER, WI 54521
PHONE: (715) 479-2570 - FAX: (715) 479-7274

Survey For:

Lake Forest Resort & Club
1531 Golf View Road
Eagle River, WI 54521

MAP NO. 2007026
DATE: 11/09/07
DWN. BY: CSM



First Addendum to
Lake Forest Resort & Club
a condominium
Town of Washington
Vilas County, Wisconsin

Units 117-124
Upper Level

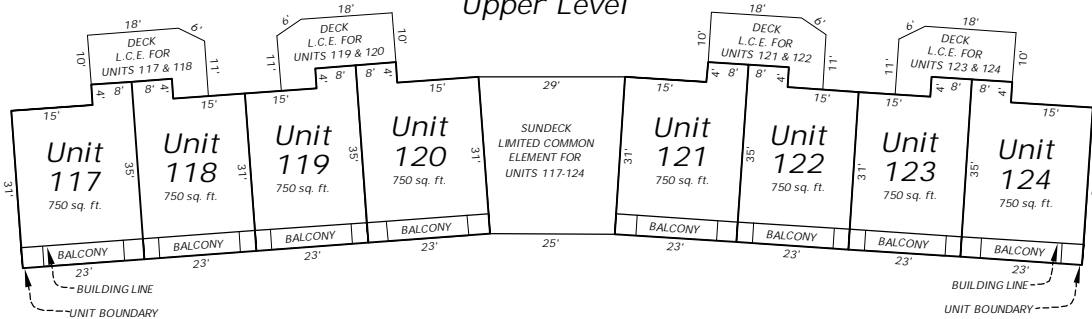

Lower Level

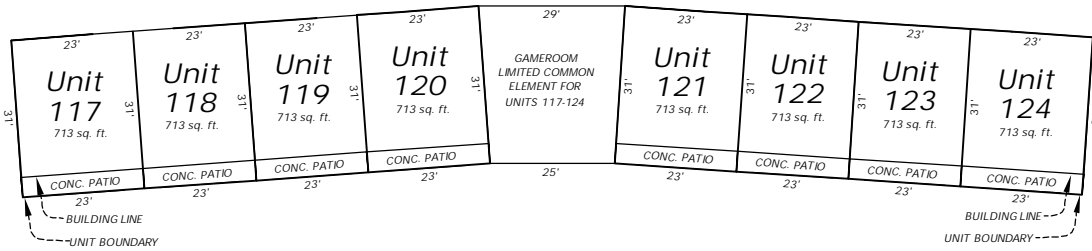

Common Element Buildings

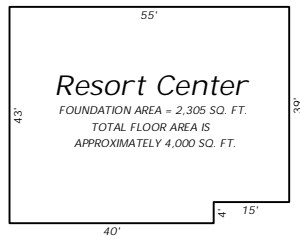

Bike Shed

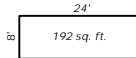

Shed 1



Shed 2



Fish House



Maintenance Garage

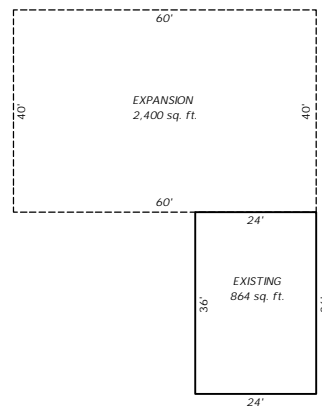

NOTES:
FOR BUILDING LOCATIONS AND
ORIENTATION SEE SHEET 1

EACH UNIT CONTAINS 2 BEDROOMS

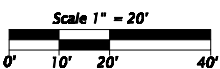

**Favorite, Anderson & Malnes
Surveying, S.C.**

5230 HWY 70 WEST - EAGLE RIVER, WI 54521
PHONE: (715) 479-2570 - FAX: (715) 479-7274

Survey For:

Lake Forest Resort & Club
1531 Golf View Road
Eagle River, WI 54521

MAP NO. 2007026
DATE: 11/09/07
DWN. BY: CSM